

FEAL

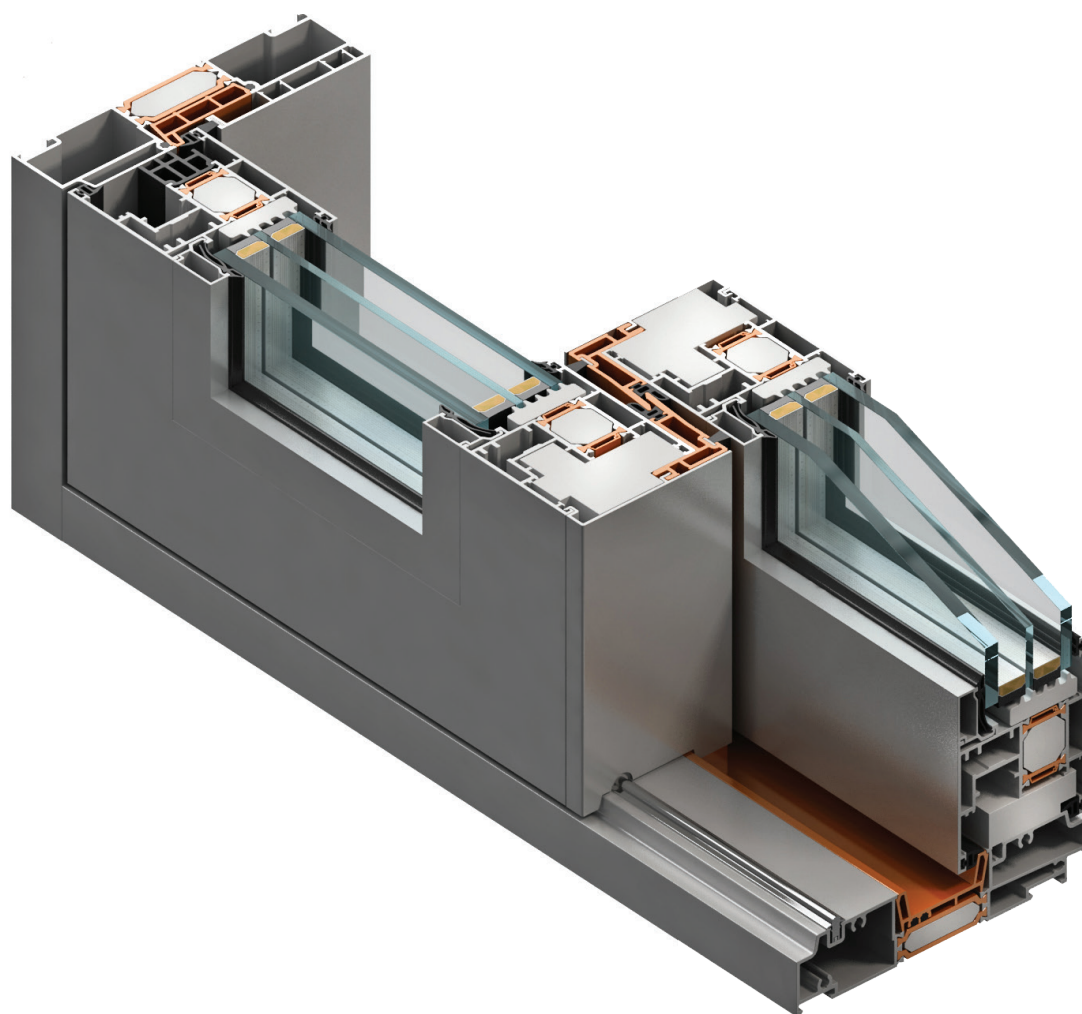

TERMO 150

PODIZNO-KLIZNA VRATA
LIFT & SLIDE DOORS

Knjiga A / *Book A*

SADRŽAJ - CONTENT

01	ZNAČAJKE SISTEMA	406.01.001-005
01	SYSTEM CHARACTERISTICS	406.01.001-005
02	ISPITIVANJA I CERTIFIKATI	406.02.000-009
02	TESTING AND CERTIFICATES	406.02.000-009
03	PROFILI	406.03.000-063
03	PROFILES	406.03.000-063
04	PRIKAZ STAKLJENJA	406.04.000-003
04	GLAZING	406.04.000-003
05	PRESJECI TERMO 150 (podizno klizno)	406.05.000-031
05	CROSS SECTIONS TERMO 150 (lift and sliding)	406.05.000-031
05	PRESJECI TERMO 150 plus (podizno klizno s fiksnim dijelom)	406.05.100-127
05	CROSS SECTIONS 150 plus (lift and sliding with fixed part)	406.05.100-127

TIPOLOGIJA IZRADE
 TYPOLOGY OF PRODUCTION

Termo 150

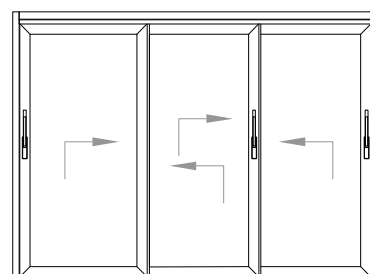
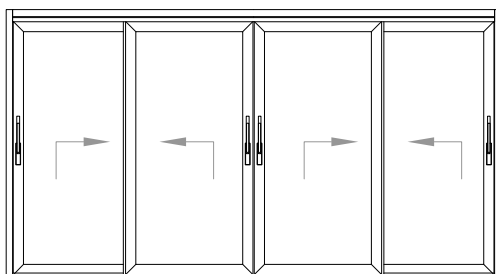
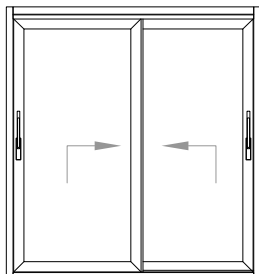

Termo 150 plus

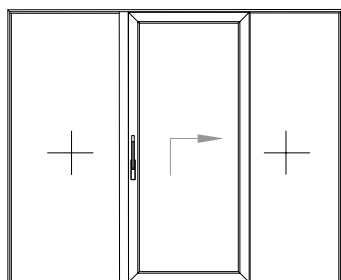
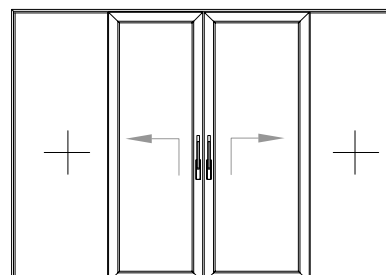
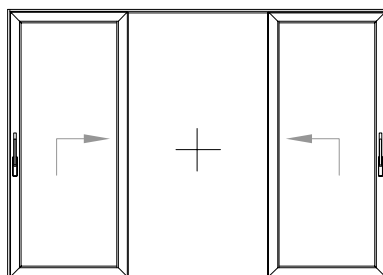
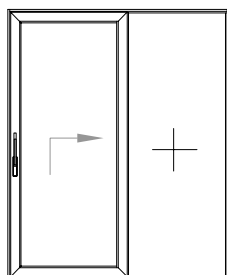

Značajke sistema

System characteristics

PODIZNO KLIZNI SISTEM VRATA
LIFT AND SLIDE DOORS SYSTEM

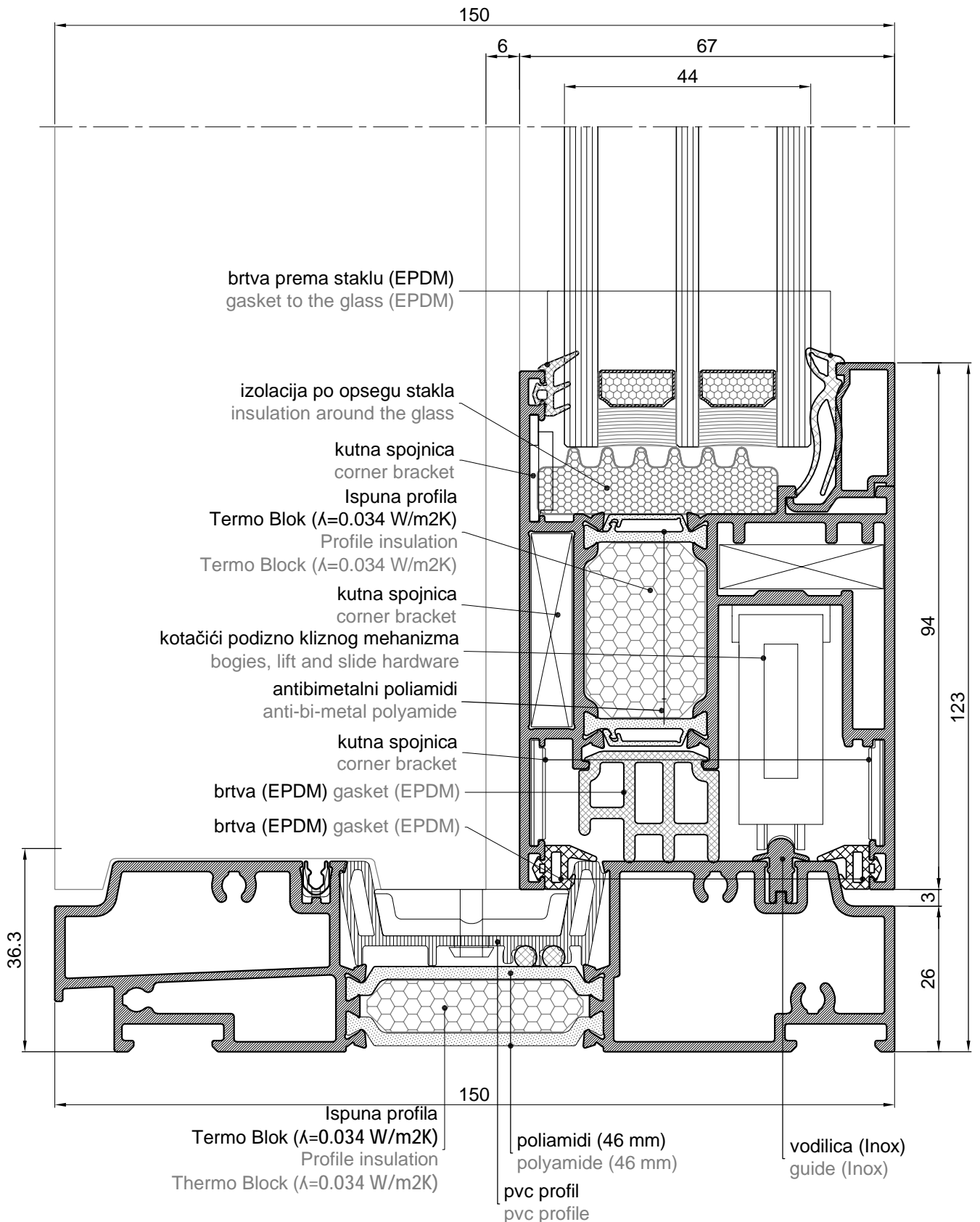

OPIS SISTEMA TERMO 150

DESCRIPTION OF SYSTEM TERMO 150

Sistem Termo 150 koristi se za izradu podizno-kliznih vrata (dvokrilnih, trokrilnih i četverokrilnih). Profili su izvedeni s prekinutim toplinskim mostom osnovne ugradbene dubine rama 150 mm (dvostazno) i 233 mm (trostazno), dubine krila 67 mm te vidljive širine rama 26 mm.

Prekid toplinskog mosta postiže se poliamidnim trakama (46 mm za ram i 22 mm za krilo (antibimetalni)).

Radi poboljšanja toplinskih karakteristika (smanjenja toplinske provodljivosti) u komore profila se ugrađuju trake od ekstrudiranog polistirena (XPS-a).

U kombinaciji s troslojnim staklom i odgovarajućim distancerom stakla sistem može postići ukupni koeficijent prolaska topline $U_d=1$ [W/m²K].

Brtvljenje između krila i rama izvedeno je EPDM brtvama.

Staklo je u krilu učvršćeno unutarnjim letvicama te zabrtvljeno EPDM brtvama s obje strane.

Okov je sistemski (podizno-klizni) različitih proizvođača (GU, Hautau, Notter...).

System Termo 150 is used for the production of lift & slide doors (double-lite, three-lite and four-lite slide door).

Profiles are made with thermal break, basic mounting depth for frame is 150 mm (double-track frame) and 233 mm (triple-track frame), depth on sash is 67 mm with visible frame widths of 26 mm.

Thermal brake is achieved with polyamide tapes (46 mm for frame and 22 mm for sash (anti-bi-metal)).

For improved thermal characteristics (reduction of thermal conductivity) polyester insulation tapes (XPS) are embedded into profile chambers.

In combination with three pane glass and adequate spacer system can reach total thermal transmittance coefficient of $U_d=1$ [W/m²K].

Sealing between frame and sash is done the EPDM gasket.

Glass in sash is fixed with inner profile and sealed with EPDM gaskets on both side.

Hardware (lift-slide) is systemic and from different manufacturers (GU, Hautau, Notter...).

Karakteristike sistema:

-materijal.....	EN AW-6060
-masa krila.....	do 330 kg
-debljina stakla.....	14-54 mm
-materijal za brtvljenje (EPDM).....	DIN 7863
-zrakopropusnost.....	EN 12207 (klasa 4)
-vodonepropusnost.....	EN 12208 (klasa E1050)
-otpornost na udar vjetrova.....	EN 12210 (klasa C4/B4)
-proračun U_d koeficijenta.....	DIN EN ISO 10077-2
-površinska obrada.....	DIN 17611
-kontrola kvalitete.....	DIN EN ISO 9001

System characteristics:

-material.....	EN AW-6060
-sash weight.....	up to 330 kg
-glass thickness.....	14-54 mm
-material for sealing (EPDM).....	DIN 7863
-air permeability.....	EN 12207 (class 4)
-water tightness.....	EN 12208 (class E1050)
-resistance to wind.....	EN 12210 (class C4/B4)
-calculation of U_d coefficient.....	DIN EN ISO 10077-2
-surface treatment.....	DIN 17611
-quality control.....	DIN EN ISO 9001

PODIZNO KLIZNI SISTEM VRATA SA INTEGRIRANIM FIKSNIM DIJELOM
LIFT AND SLIDE DOOR SYSTEM WITH THE INTEGRATED FIXED PART

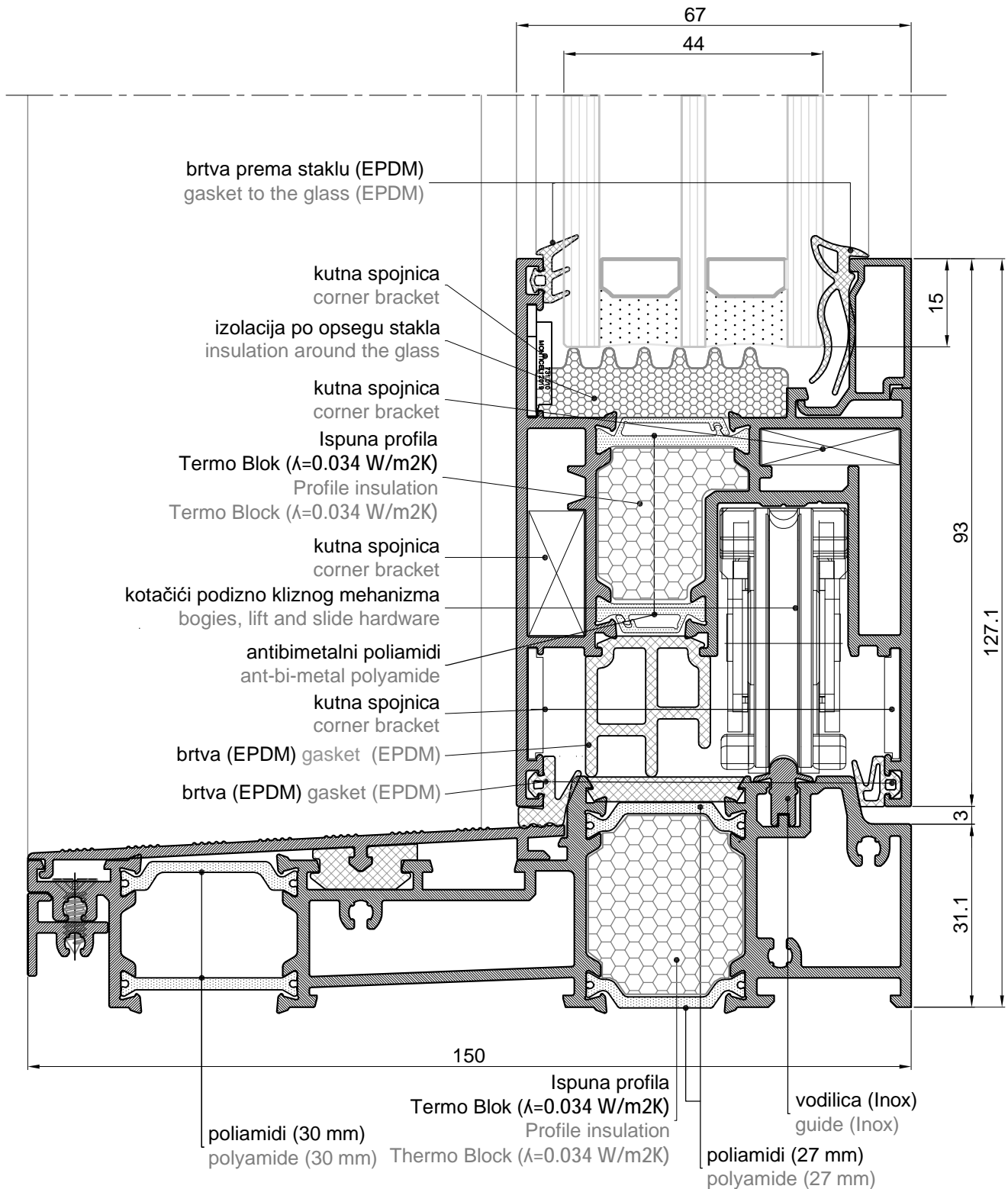

OPIS SISTEMA TERMO 150 plus
DESCRIPTION OF SYSTEM TERMO 150 plus

Sistem Termo 150 plus koristi se za izradu podizno-kliznih vrata (jedno krilo podizno klizno+fiksno, dva srednja krila podizno klizna bokovi fiksni i srednje krilo podizno klizno a bokovi fiksni).

Profili su izvedeni s prekinutim toplinskim mostom osnovne ugradbene dubine rama 150 mm, dubine krila 67 mm te vidljive širine rama 32 mm.

Prekid toplinskog mosta postiže se poliamidnim trakama (30 i 27 mm za ram i 26 i 18.6 mm za krilo (antibimetalni)).

Radi poboljšanja toplinskih karakteristika (smanjenja toplinske provodljivosti) u komore profila se ugrađuju trake od ekstrudiranog polistirena (XPS-a).

U kombinaciji s troslojnim staklom i odgovarajućim distancerom stakla sistem može postići ukupni koeficijent prolaska topline $U_d=1$ [W/m²K].

Brtvljenje između krila i rama izvedeno je EPDM brtvama.

Staklo je u krilu učvršćeno unutarnjim letvicama te zabrtvljeno EPDM brtvama s obje strane.

Okov je sistemski (podizno-klizni) različitih proizvođača (Hautau, Notter...).

System Termo 150 plus is used for the production lift & slide doors (single sash lift & slide+fixed, double central sashes lift & slide with side profile fixed and central sash is lift & slide and side profile fixed). Profiles are made with thermal break, basic mounting depth for frame is 150 mm, depth on sash is 67 mm with visible frame width of 32 mm.

Thermal brake is achieved with polyamide tapes (30 i 27 mm for frame and 26 i 18.6 mm for sash (anti-bi-metal)).

For improved thermal characteristics (reduction of thermal conductivity) polyester insulation tapes (XPS) are embedded into profile chambers.

In combination with three pane glass and adequate spacer system can reach total thermal transmittance coefficient of $U_d=1$ [W/m²K].

Sealing between frame and sash is done the EPDM gasket.

Glass in sash is fixed with inner profile and sealed with EPDM gasket on both sides

Hardware (lift-slide) is systemic and from different manufacturers (GU, Hautau, Notter...).

Karakteristike sistema:

-materijal.....	EN AW-6060
-masa krila.....	do 330 kg
-debljina stakla.....	14-54 mm
-materijal za brtvljenje (EPDM).....	DIN 7863
-zrakopropusnost.....	EN 12207 (klasa 4)
-vodonepropusnost.....	EN 12208 (klasa E1050)
-otpornost na udar vjetra.....	EN 12210 (klasa C4/B4)
-proračun U_d koeficijenta.....	DIN EN ISO 10077-2
-površinska obrada.....	DIN 17611
-kontrola kvalitete.....	DIN EN ISO 9001

System characteristics:

-material.....	EN AW-6060
-sash weight.....	up to 330 kg
- glass thickness.....	14-54 mm
-material for sealing (EPDM).....	DIN 7863
-air permeability.....	EN 12207 (klasa 4)
-water tightness	EN 12208 (klasa E1050)
-resistance to wind.....	EN 12210 (klasa C4/B4)
-calculation of U_d coefficient.....	DIN EN ISO 10077-2
-surface treatment.....	DIN 17611
-control quality.....	DIN EN ISO 9001